

# Wire Harness and Splitters

## Installation Instructions

- It is the responsibility of the installer to meet all code and safety requirements and to obtain all required building permits. The installer should determine and implement the installation techniques appropriate for each unique installation situation. Digger Specialties, Inc. and its distributors shall not be held liable for improper or unsafe installations.
- These instructions must be followed exactly as written and the materials used must be exactly as shown in the instructions. Any deviation from the instructions or variation in the materials used/installed may result in an unsuccessful installation and will void the warranty.

### Parts List

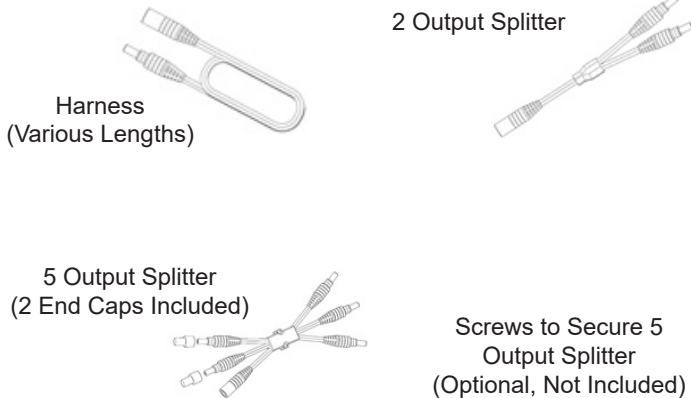

### Important Notes

- The use of non Magena Star® products with Magena Star® Lighting including Transformers, Wire Harnesses, and Splitters may void the warranty.
- Do not cut any wires. Any extra wire length can be coiled.
- Ensure that staples, used to hold wires in place, and all other screws or brackets will not damage or pinch any of the wires.
- Connections can be made by firmly pushing the male and female connectors together and slightly twisting while pushing.
- During installation, it is recommended that you confirm each light is functional before installation is complete.
- Direct bury is not recommended. If the harness is to be used underground, it should be ran inside of conduit. Any wire connections should be made above ground.

### Harness

1. The Harness is used to extend power from the transformer to each individual light or splitter. The Harness has a male and female end.
2. Harnesses can be plugged into each other to extend length if needed.
3. The Harness can be run underneath the deck (above ground) and/or inside the post/railing where it is hidden from view.

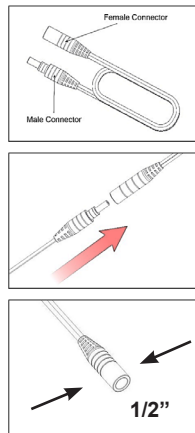

### 2 Output Splitter

1. The 2 Output Splitter is used to evenly distribute power from 1 input to 2 outputs.
2. Plug the male connector from a harness into the female input connector of the 2 Output Splitter. Press firmly until the connection is fully engaged.
3. Plug the female connector from a harness or a light into one of the male output connectors. Repeat for the other output connector.

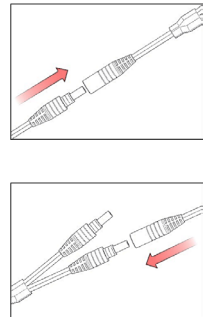

Continued on Page 2

# Wire Harness and Splitters

## Installation Instructions

- *It is the responsibility of the installer to meet all code and safety requirements and to obtain all required building permits. The installer should determine and implement the installation techniques appropriate for each unique installation situation. Digger Specialties, Inc. and its distributors shall not be held liable for improper or unsafe installations.*
- *These instructions must be followed exactly as written and the materials used must be exactly as shown in the instructions. Any deviation from the instructions or variation in the materials used/installed may result in an unsuccessful installation and will void the warranty.*

## 5 Output Splitter

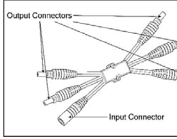
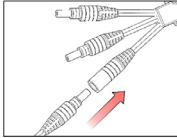
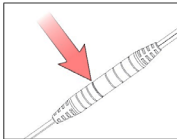
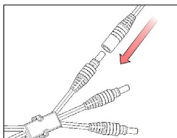
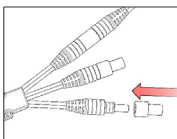
1. The 5 Output Splitter is used to evenly distribute power from 1 input to 5 outputs.
2. Plug the male connector from a harness into the female input connector of the 5 Output Splitter. Press firmly until the connection is fully engaged.
3. Connection is fully engaged when there is minimal gap between the male harness connector and the female input connector.
4. Plug the female connector from a harness or a light into one of the male output connectors. Repeat for each output connector that is needed.
5. If there are any unused output connectors, an end cap (2 included) must be used to seal the output connector. Any unused end caps can be saved or discarded. If there are more than 2 unused output connectors, a 2 Output Splitter should be used.
6. The 5 Output Splitter can be secured using (2) #2 Stainless Steel Screws (not supplied).