

# 50 Watt Transformer

## Installation Instructions

- It is the responsibility of the installer to meet all code and safety requirements and to obtain all required building permits. The installer should determine and implement the installation techniques appropriate for each unique installation situation. Digger Specialties, Inc. and its distributors shall not be held liable for improper or unsafe installations.
- These instructions must be followed exactly as written and the materials used must be exactly as shown in the instructions. Any deviation from the instructions or variation in the materials used/installed may result in an unsuccessful installation and will void the warranty.

### Parts List

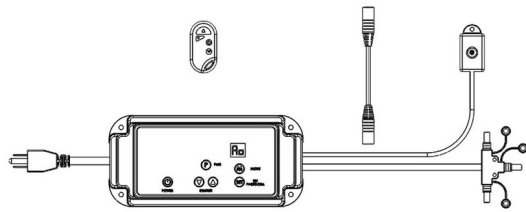

50 Watt Transformer Bluetooth  
with Photocell, Timer, and Remote

- (5) #6 or #8 stainless steel screws (not included)  
(4) to mount the Transformer  
(1) to mount the Photocell

- (2) #4 x 1" stainless steel screws (not included)  
(2) to mount the Tee Connector

### Important Notes

- Transformer must be plugged into a GFCI outlet.
- Transformer can support up to 50 watts output.
- Do not cut any wires. Any extra wire length can be coiled.
- Do not use extension cords.
- Do not use within 10 feet of ponds, pools, or other open sources of water.
- Ensure that staples, used to hold wires in place, and all other screws or brackets will not damage or pinch any of the wires.
- Keep away from external heat sources.
- Connections can be made by firmly pushing the male and female connectors together and slightly twisting while pushing.
- During installation, it is recommended that you confirm each light is functional before installation is complete.
- Wiring harness should have enough slack so light fixture can be removed if future replacement is needed.

### Step 1: Mount the Transformer and Photocell

1. Use (4) stainless steel screws (not included) to mount the transformer a minimum of 12" above the ground level and within reach of a 120V AC GFCI outlet. The 120V AC power cord attached to the transformer is 5' long. The transformer can be mounted under the deck but the control panel on the transformer should be accessible to change settings.
2. Plug the transformer into the GFCI outlet.
3. Use a stainless steel screw (not included) to mount the photocell in a location that can sense dusk and dawn (night and day) conditions. The attached photocell cord is 5' long.

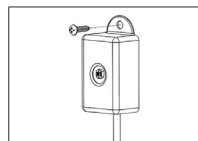
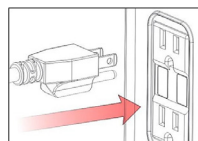
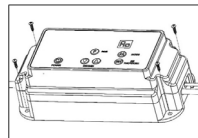

### Step 2: Mount the Tee Connector

1. Run the 4' output power cable with the Tee Connector attached to the location of the first light or a central location if lights will be located in multiple directions. The Tee Connector can be secured loosely using (2) #4 x 1" stainless steel screws (not supplied). Do not tighten the screws completely as this can damage the Tee Connector.
2. If needed, all three of the output connectors on the Tee Connector are active and will supply equal power to the entire system.
3. Any unused Tee Connector terminals or splitters in the system must be sealed using the attached cap.

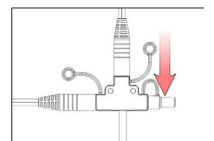
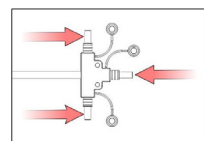
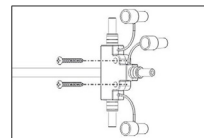

See Page 2 for Step 3 & 4

# 50 Watt Transformer

## Installation Instructions

- *It is the responsibility of the installer to meet all code and safety requirements and to obtain all required building permits. The installer should determine and implement the installation techniques appropriate for each unique installation situation. Digger Specialties, Inc. and its distributors shall not be held liable for improper or unsafe installations.*
- *These instructions must be followed exactly as written and the materials used must be exactly as shown in the instructions. Any deviation from the instructions or variation in the materials used/installed may result in an unsuccessful installation and will void the warranty.*

### Step 3: Install the Lights and Finalize Installation

1. Connect the rest of the Main Wiring Connections (not included) per their instructions on reverse side of page.
2. Connect the desired light fixtures (not included) per their individual instructions.
3. Refer to the included Control instructions for operation of the transformer. The Control instructions should be retained for future reference.

### Step 4: Closed Loop Connector (Optional but Recommended)

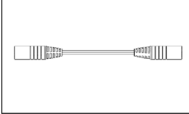
1. Included with the transformer is a closed loop connector. The closed loop connector has a red female connector on each end and is 6" long. The closed loop connector is used to connect the Main Wiring back into the transformer. This reduces the voltage drop across the wiring in the system.
2. Use a two output splitter on the last light fixture of the run. Plug the last light fixture into one of the two outputs splitters male connections. Plug an extension harness into the other male connection of the two output splitter. Run enough extension harnesses end to end to reach back to the Tee Connector of the transformer. Use the closed loop connector to make the connection between the extension harness and the Tee Connector.