

# 12 Watt Transformer

## Installation Instructions

- It is the responsibility of the installer to meet all code and safety requirements and to obtain all required building permits. The installer should determine and implement the installation techniques appropriate for each unique installation situation. Digger Specialties, Inc. and its distributors shall not be held liable for improper or unsafe installations.
- These instructions must be followed exactly as written and the materials used must be exactly as shown in the instructions. Any deviation from the instructions or variation in the materials used/installed may result in an unsuccessful installation and will void the warranty.

### Parts List

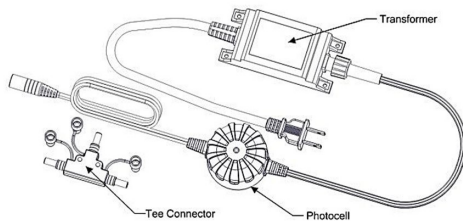

12 Watt Transformer with Photocell

- (4) #4 x 1/2" screws  
(not included)
- (4) to mount the Transformer

### Important Notes

- Transformer must be plugged into a GFCI outlet.
- Transformer can support up to 12 watts.
- Do not cut any wires. Any extra wire length can be coiled.
- Do not use extension cords.
- Do not use within 10 feet of ponds, pools, or other open sources of water.
- Ensure that staples, used to hold wires in place, and all other screws or brackets will not damage or pinch any of the wires.
- Connections can be made by firmly pushing the male and female connectors together and slightly twisting while pushing.
- During installation, it is recommended that you confirm each light is functional before installation is complete.
- Wiring harness should have enough slack so light fixture can be removed if future replacement is needed.

### Step 1: Prepare the Transformer

1. Properly align the photocell plug with the transformer receptacle and firmly push the plug into place.
2. Tighten the plastic nut by turning clockwise. If the photocell is already attached, check to make sure plastic nut is completely tight for a weatherproof seal.

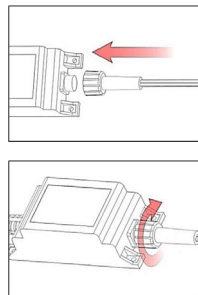

### Step 2: Mount the Transformer and Photocell

1. Use (4) #4 x 1/2" screws (not supplied) to mount transformer to an exterior wall surface or deck face a minimum of 12" above ground level. Plug the transformer into the GFCI outlet.

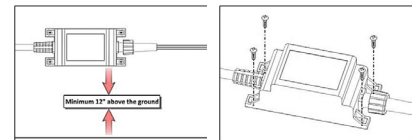

2. Mount the round photocell holder next to the transformer with the supplied screw. Ensure the location of the photocell can sense dusk and dawn.



3. Peel off the protective film covering the adhesive on the top surface of the round photocell holder. Align the photocell and press firmly onto the adhesive.

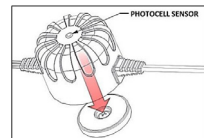

4. To test the power supply during installation, temporarily cover the photocell sensor with dark tape so the lights will come on during installation. Be sure to remove the tape for normal operation. (Photocell Sensor is shown in Step Three.)

See Page 2 for Step 3

# 12 Watt Transformer

## Installation Instructions

- *It is the responsibility of the installer to meet all code and safety requirements and to obtain all required building permits. The installer should determine and implement the installation techniques appropriate for each unique installation situation. Digger Specialties, Inc. and its distributors shall not be held liable for improper or unsafe installations.*
- *These instructions must be followed exactly as written and the materials used must be exactly as shown in the instructions. Any deviation from the instructions or variation in the materials used/installed may result in an unsuccessful installation and will void the warranty.*

### Step 3: Plug in Tee Connector

1. Run the 9' power cable from the photocell to the location of the first light fixture. If needed, the power cable can fit through a 1/2" hole.

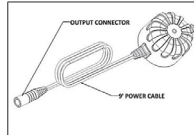

2. Plug the output connector from the photocell into the supplied T-Connector. Press firmly until the connection is fully engaged.

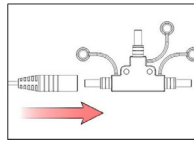

3. Connection is fully engaged when there is minimal gap between the output and Tee connectors.

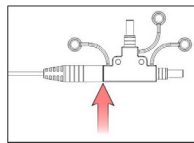

4. Connect light fixtures per their instructions.

5. Any unused Tee Connector terminals or splitters in the system must be sealed using the attached cap.

