

Standard 4" Aluminum Post Mount (Residential)

Installation Instructions

- It is the responsibility of the installer to meet all code and safety requirements, and to obtain all required building permits. The installer should determine and implement the installation techniques appropriate for each unique installation situation. Digger Specialties, Inc. and its distributors shall not be held liable for improper or unsafe installations.
- These instructions must be followed exactly as written and the materials used must be exactly as shown in the instructions. Any deviation from the instructions or variation in the materials used/installed may result in an unsuccessful installation and will void the warranty.

Concrete Surface Installation:

Place aluminum post mount into position. Fasten aluminum post mount to concrete using (4) 1/4" x 3" concrete screws (screws not included). Slide the 4" vinyl post and flair down over the aluminum mount to approximately 6" from the floor.

Level vinyl post by using the leveling nuts on aluminum post mount. A 1/2" open end wrench will be needed for this. Once all the leveling nuts are tight, slide the vinyl post with flair to the floor.

When railing system is installed, at least 2 screws from external railing mounts will go through the vinyl post and into the bottom block to secure the vinyl post to the mount.

Wood Surface Installation:

Place aluminum post mount into position. Fasten aluminum post mount to wood surface using (4) 1/4" x 5" or longer stainless-steel lags (lags not included). Slide the 4" vinyl post and flair down over the aluminum mount to approximately 6" from the floor.

Level vinyl post by using the leveling nuts on the aluminum post mount. A 1/2" open end wrench will be needed for this. Once all the leveling nuts are tight, slide the vinyl post with flair to the floor.

When railing system is installed, at least 2 screws from external railing mounts will go through the vinyl post and into the bottom block to secure the vinyl post to the mount.

WARNING: When installing the Aluminum Post Mount on top of a wood structure, the 5" lags MUST be lagged entirely into substrate! It will not be strong enough if it is fastened into a 5/4" or a 1 1/2" thick deck board!

Standard
Aluminum Post
Mount
(Residential)

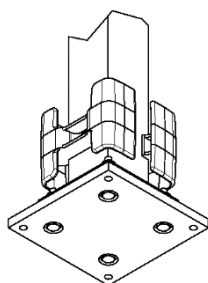

Aluminum Post Mount
position with 4" x 4"
wood support post.

4" x 4" wood post is flush
with top of wood joist.

Outside frame of wood
structure.

Aluminum Post Mount
position without 4" x 4"
wood support post.

Add extra 2" x 6" blocking (if 4" x 4" post exists, attach to 4" x 4" post). Position Aluminum Post Mount over post. All 4 lags will fasten to a joist or 2" x 6" board.