

REV.	REVISION	DATE
A	RELEASED TO PRODUCTION	09-09-10
C	Added Welding Notes	09-10-10
D	Corrected alloy to 6005-T5	09-10-10
E	Added welding Notes	03-14-11
F	Screw length verified	03-15-11

# 171016 = 37" Power Post (for 36" Tall Rail)  
 # 171018 = 43" Power Post (for 42" Tall Rail)  
 Tolerance = ± 1/16"

Post and plate must be free of dirt and grease before welding

Weld sides of post to plate following number sequence of 1,2,3 & 4 below.

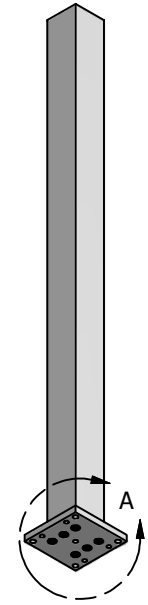

1/4" x 1/4" +/- 1/16"  
 Welded all 4 sides full length to plate with 3/64" ER 5356 wire

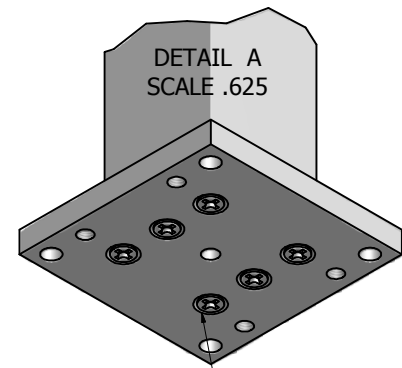
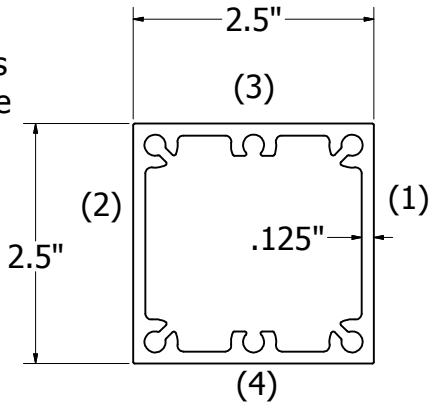

Post must be set to have bottom screw line parallel with rail line.

#14 SS Screws with min. length of 2" (6 req.)

LOC:Z/Projects/Projects 2010/CCRR for Westbury Railing/Rail and Post mounts. Associated to Z/Alumunim/Components/Post Mounts and Welded Plates/2 1/2" Sq. Post/Power Post



SHEET SIZE= C	DRAWN BY: <b>wjm</b>	MATERIAL: Aluminum 6005-T5
SCALE =	DATE DRAWN: 8/12/2010	PART NAME: Power Post 2 1/2"
STANDARD TOLERANCE: .00 .01 .000 .005 ANG: .5° FRACTIONS: ± 1/16"	APPROVED BY:	PART NUMBER: 71016 & 71018
FIRST USED:	DATE APPR'D:	REV. F