

REV.	DESCRIPTION	DATE
A	Use 56140 plate with .625" center hole	06/06/2017
B	Added part numbers and weights	02/06/2018

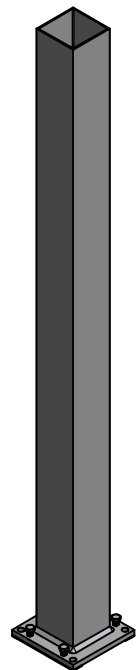
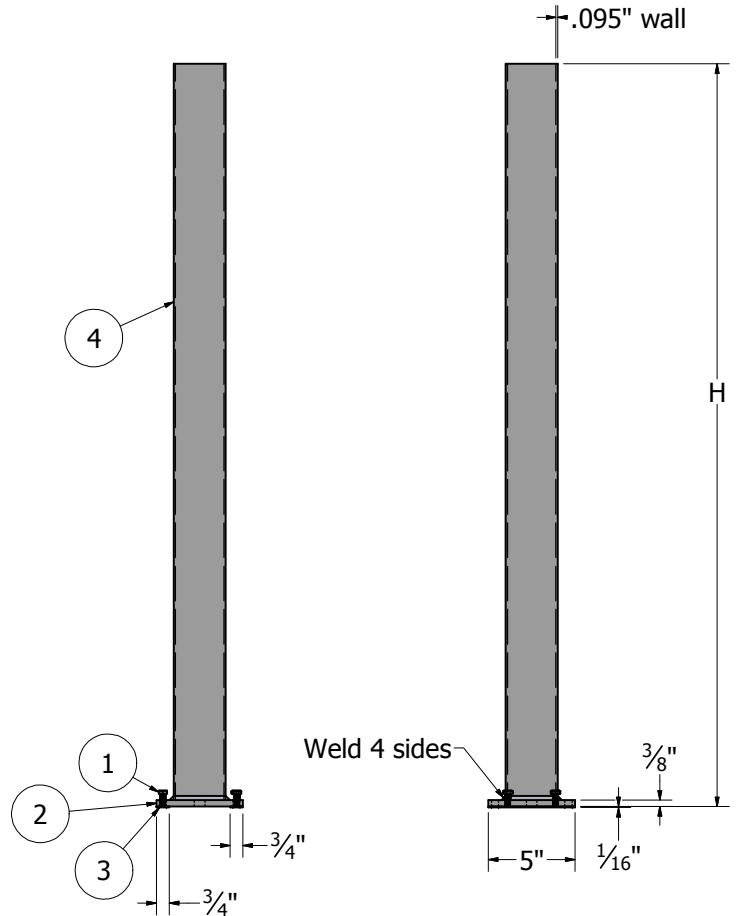
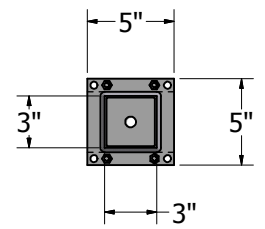

Part Number	H = Post Height	Rail Height	Stair Rail	Weight
173389	37"	36"		5.19
173391	43"	42"		5.89
173390	47"		36"	6.35
173392	53"		42"	7.05

PARTS LIST		
ITEM	QTY	PART NUMBER
1	4	10898 Bolt Hex SS 5_16-18 x 3_4
2	1	56140 Alum Plate 5 x 5 x .375
3	2	56141 Shim Plate SS
4	1	Alum Tube 3 x 3 x .095 wall

Digger Specialties Inc.
Transforming the Outdoor Living Experience
 3446 US 6 EAST
 BREMEN, IN 46506
www.diggerspecialties.com

WEIGHT: See table
 STANDARD TOLERANCE: .00 .01
 .000 .005
 ANG. .5~
 FRACTIONS: ± 1/16"
 FILE LOC: Z:\Aluminum\Components\Post Mounts, Welded Plates\3" Sq. Post\3" Welded Post Mount IRC.idw

DRAWN BY: CM
 DATE DRAWN: 12/19/2016
 DRAFT NO. 20161219-2C
 MATERIAL: Aluminum & Stainless Steel
 PART NAME: 3" Welded Post Mount IRC.idw
 PART NUMBER: See Table
 REV. B