

# 2 1/2" Stair Crossover Adapter

(2 1/2" Standard Post)

## Installation Instructions

- It is the responsibility of the installer to meet all code and safety requirements, and to obtain all required building permits. The installer should determine and implement the installation techniques appropriate for each unique installation situation. Digger Specialties, Inc. and its distributors shall not be held liable for improper or unsafe installations.
- These instructions must be followed exactly as written, and the materials used must be exactly as shown in the instructions. Any deviation from the instructions or variation in the materials used/installed may result in an unsuccessful installation and will void the warranty.

### Parts

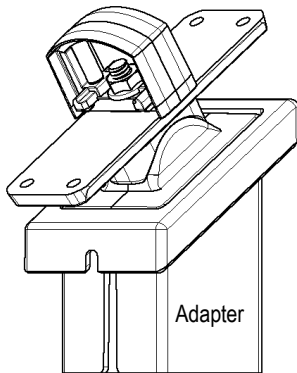

#### Tools Required

- Chop saw
- 1/2" Wrench
- String
- Drill
- #2 Bit

**Note:** This adapter is designed for the standard 2 1/2" post. This adapter is adjustable within a range of 30° to 41°. This adapter is not compatible with the 2 1/2" power post.

### Post Placement

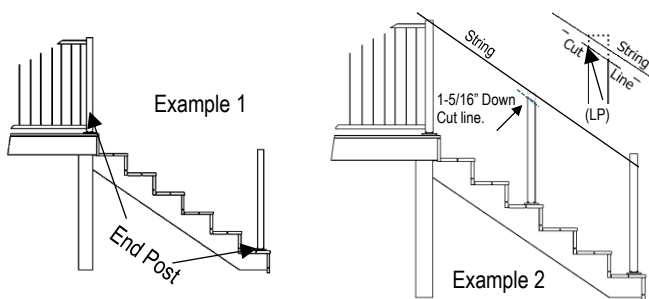

- First ensure your end posts are correctly positioned on steps according to instructions. (Example 1) (See our post placement instructions for Westbury)
- Determine the height of your top rail. Run a string between the two-end post where the **bottom** of the rail will be located.
- Place the stair post on stairs in the desired location. Measure from the nose of tread to the edge of post plate and ensure it is the same as your end post. (Example 2)

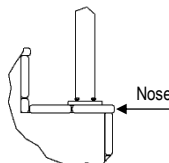

### Post Placement cont'd

- Measure down from the high side 1-5/16" and mark post. (Long Point) Set the saw at 34° and space the post equally on the table and fence sides to account for the plate. **Ensure the leveling bolts are in line with railing.**
- Cut the post and fasten in place on your steps.

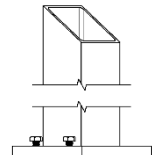

### Stair Crossover Assembly

- Place adapter into post.
- Bring your adapter up to and align to your string. This sets the height of your adapter. (Example 3)
- Pull the cover up. Secure (2) screws (#10 x 5/8") one to each opposing side, ensuring the cover conceals the screw heads. (Example 4)
- Bring cover down and over post.
- To set the angle, align your adapter with your string. Tighten your nut with a 1/2" wrench.
- Refer to Westbury stair railing instructions for guidance on cutting the railing.

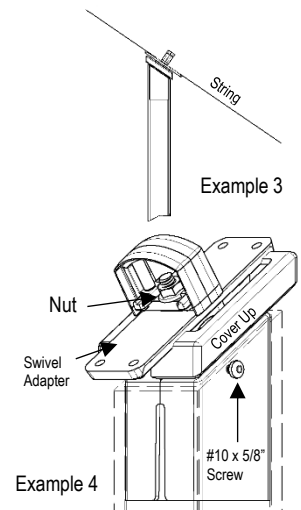

### Care and Cleaning

Remove all particles and residue from Westbury Aluminum components by referring to the Care and Cleaning requirements on the DSI website. Scan QR code.



### Warranty

For product Warranty and Registration please scan QR code:

